

IELTS Listening Test

Questions 1-5

WRITE NO MORE THAN TWO WORDS AND/ OR A NUMBER.

The Park Central Hotel Booking Form

Guest's name: *Eva* **1.** _____

Postcode: **2.** _____

Address: *40, Brick Lane, Tower Hamlets*

Mobile: *05034* **3.** _____

Check-out: *On* **4.** _____ - *four nights' stay*

Payment Method: *Bank transfer - Problem with* **5.** _____ *payment*

Payment Reference Number *8794231*

Questions 6-10

WRITE NO MORE THAN TWO WORDS AND/ OR A NUMBER FOR EACH ANSWER

The breakfast is served on the **6.** _____ *of the hotel.*

All guests are required to have suitable **7.** _____ *on in the swimming pool and the steam room.*

Eva can watch the football game at the gym since the sports **8.** _____ *is booked.*

Eva should visit the **9.** _____ *to get a free city map.*

Eva needs to wake up at **10.** _____ *in the morning.*

More questions on the next page

Questions 11-15

Choose the correct letter, **A**, **B**, or **C**.

11. Retford centre was initially closed

- A.** because it had become dangerous.
- B.** since it was necessary to add modern facilities.
- C.** to make it accessible to children.

Answer _____

12. The cultural centre was relocated because

- A.** it didn't have an emergency exit.
- B.** it didn't get enough sunlight.
- C.** it didn't have enough space for cultural activities.

Answer _____

13. The costs of renovation were largely supplied through

- A.** the local community.
- B.** a literacy institute.
- C.** the town council.

Answer _____

14. The centre is open on

- A.** Saturday mornings
- B.** public holidays
- C.** Sunday mornings

Answer _____

15. If you request a book from the centre's new loan service

- A.** you have to pay a service charge.
- B.** you'll be contacted when it arrives.
- C.** it will be sent to you in a couple of days.

Answer _____

More questions on the next page

Questions 16-20

Label the plan below of the Retford recreation centre.

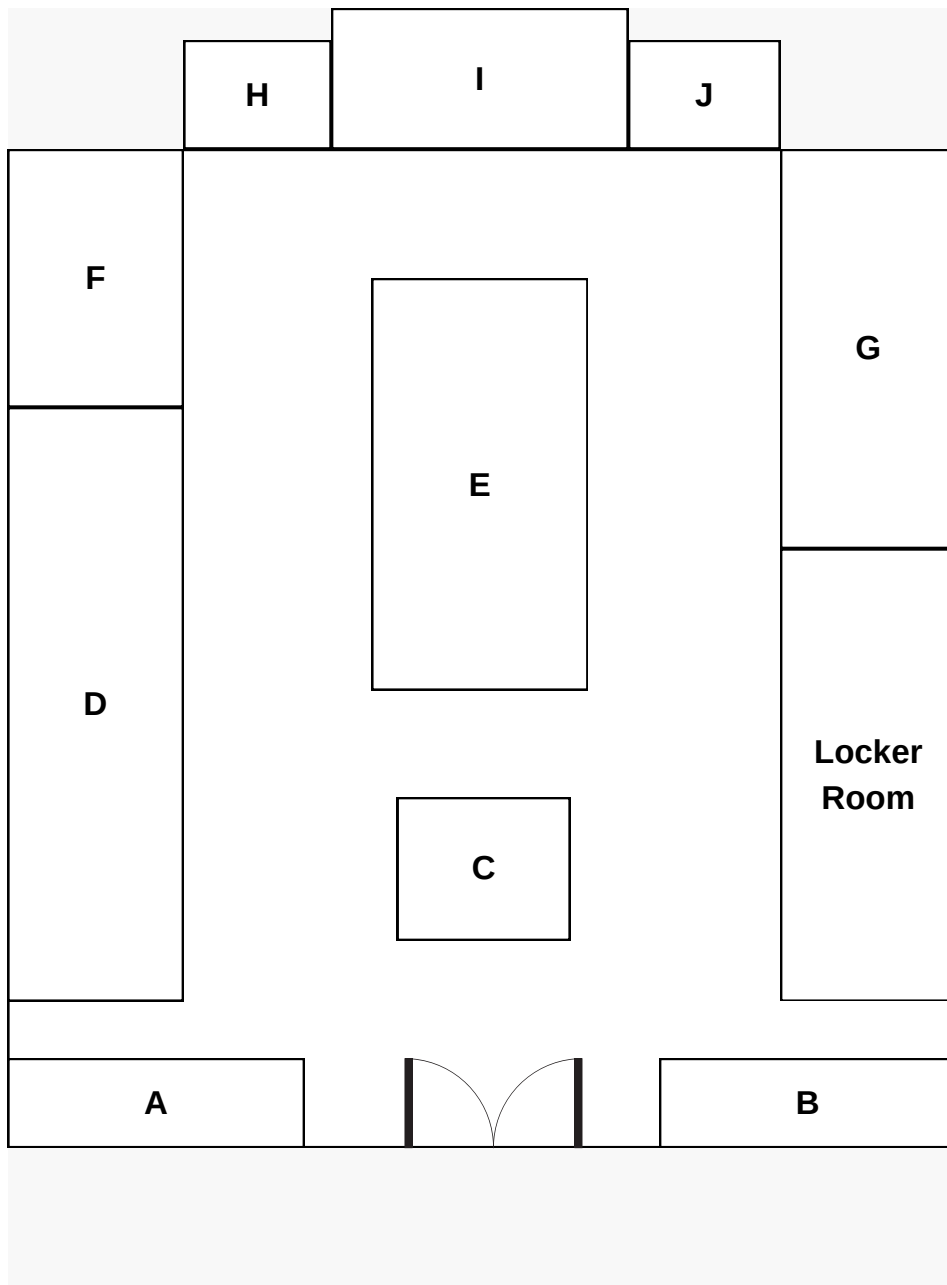

- 16. Reception area _____
- 17. Community meeting room _____
- 18. Culture centre _____
- 19. Indoor playground _____
- 20. Student study zone _____

More questions on the next page

Questions 21-25

WRITE **NO MORE THAN ONE WORD**.

Photograph Type	Inventor	Notes on the process
The Daguerreotype	Lous Daguerreo	<ul style="list-style-type: none">the silvered copper plate containing the image was exposed to light and mercury vapour.a combination of chemicals was used to remove the 21. _____ to light.The result was black-and-white photographs.
The Hillotype	Levi Hill	<ul style="list-style-type: none">Hill claimed his photographs were 22. _____ coloured.Hill was his accused of being a 23. _____ since he didn't make the details public.After 156 years, it was finally proved that Hill was a 24. _____Research shows that some of Hill's pictures were 25. _____ with fake colours.

Questions 26-30

Complete Brian's notes below.

WRITE **ONE WORD ONLY** FOR EACH ANSWER.

Notes on my Presentation

Dr. Benson said I spoke accurately and didn't bombard my **26.** _____ with unrelated information.

Dr. Benson advised me to keep the text on each slide short and to the point so listeners can **27.** _____ and remember the main points.

Dr. Benson emphasised that I should collect factual information and **28.** _____ by doing historical research.

Dr. Benson mentioned that I must revise my **29.** _____ to cite the references and to it professionally.

Dr. Benson informed me that the final grades can be found initially on the **30.** _____ by the 20th of September.

More questions on the next page

Questions 31-38

Complete the summary related to the use of GPS in agriculture

WRITE **ONLY ONE WORD AND/OR A NUMBER** IN EACH GAP

GPS in agriculture

Importance of GPS and GIS

- GPS and GIS have enabled us to combine **31.** _____ data with local information.
- GPS allows farmers to work efficiently in adverse weather conditions, or when the **32.** _____ is poor.

GPS in modern agriculture

- Exact dosing and dispersion of chemical result in increased **33.** _____ , lower costs and less damaged to the environment.
- Use of processors, sensors and monitoring systems has led to **34.** _____ in precision farming.

Examples of low-cost precision agriculture

1. A smartphone app

- Currently in the **35.** _____ phase.
- Will become publicly accessible within **36.** _____

2. A moisture sensor

- Allows farmers to plan the schedule of irrigation.
- Operates within **37.** _____ energy and assesses the type of soil, drainage, and weather patterns.

3. A GPS based system

- A sensor detects and locates green plants.
- Checks its **38.** _____ on the map to find to find a corresponding plant and kills the weed.

More questions on the next page

Questions 39-40

Complete the diagram below related to the adjustment of GPS accuracy.

WRITE NO MORE THAN TWO WORDS FOR EACH ANSWER.

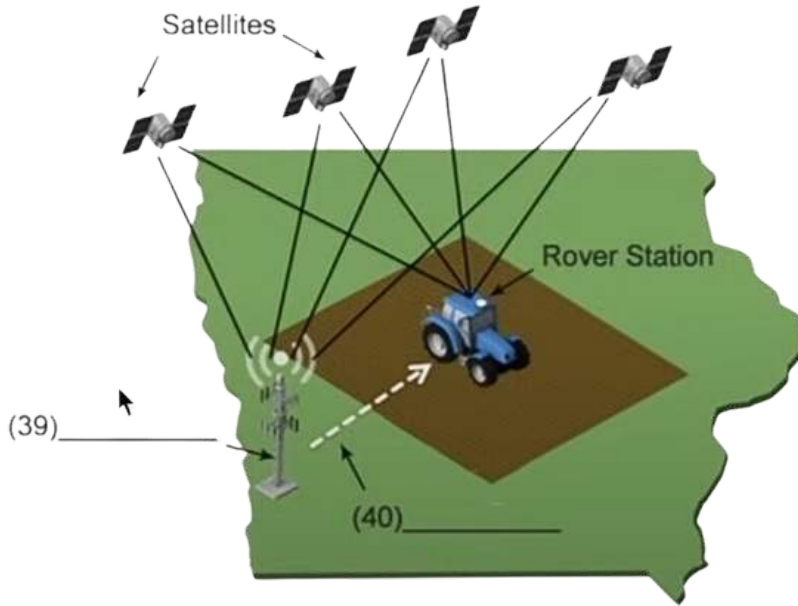

Solutions

20. G	40. Radio Link
19. F	39. Base Station
18. I	38. coordinates
17. E	37. solar
16. C	36. 2 years
15. B	35. development
14. C	34. breakthroughs
13. B	33. yields
12. B	32. visibility
11. A	31. real-time
10. 7	30. noticeboard
9. front desk	29. sources
8. lounge	28. statistics
7. swimwear	27. digest
6. first floor	26. audience
5. online	25. enhanced
4. August 20th	24. genius
3. 689427	23. fraud
2. SWA 632	22. naturally
1. Clarke	21. sensitivity